

# FLENDER COUPLINGS

---

RUPEX

---

Operating Instructions 3601en  
Edition 10/2017

---

RWN, RWS

---





## FLENDER COUPLINGS

### RUPEX 3601en

#### Operating Instructions

RWN, RWS

<u>Introduction</u>	<b>1</b>
<u>Safety instructions</u>	<b>2</b>
<u>Description</u>	<b>3</b>
<u>Application planning</u>	<b>4</b>
<u>Assembly</u>	<b>5</b>
<u>Commissioning</u>	<b>6</b>
<u>Operation</u>	<b>7</b>
<u>Servicing</u>	<b>8</b>
<u>Service and support</u>	<b>9</b>
<u>Disposal</u>	<b>10</b>
<u>Spare parts</u>	<b>11</b>
<u>Technical data</u>	<b>A</b>
<u>Quality documents</u>	<b>B</b>

## Legal information

### Warning notice system

This manual contains notices you have to observe in order to ensure your personal safety, as well as to prevent damage to property. The notices referring to your personal safety are highlighted in the manual by a safety alert symbol, notices referring only to property damage have no safety alert symbol. These notices shown below are graded according to the degree of danger.

 <b>DANGER</b>
indicates that death or severe personal injury <b>will</b> result if proper precautions are not taken.

 <b>WARNING</b>
indicates that death or severe personal injury <b>may</b> result if proper precautions are not taken.

 <b>CAUTION</b>
indicates that minor personal injury can result if proper precautions are not taken.

<b>NOTICE</b>
indicates that property damage can result if proper precautions are not taken.

If more than one degree of danger is present, the warning notice representing the highest degree of danger will be used. A notice warning of injury to persons with a safety alert symbol may also include a warning relating to property damage.

### Qualified Personnel

The product/system described in this documentation may be operated only by **personnel qualified** for the specific task in accordance with the relevant documentation, in particular its warning notices and safety instructions. Qualified personnel are those who, based on their training and experience, are capable of identifying risks and avoiding potential hazards when working with these products/systems.

### Proper use of Flender products

Note the following:

 <b>WARNING</b>
Flender products may only be used for the applications described in the catalog and in the relevant technical documentation. If products and components from other manufacturers are used, these must be recommended or approved by Flender. Proper transport, storage, installation, assembly, commissioning, operation and maintenance are required to ensure that the products operate safely and without any problems. The permissible ambient conditions must be complied with. The information in the relevant documentation must be observed.

### Trademarks

All names identified by ® are registered trademarks of Flender GmbH. The remaining trademarks in this publication may be trademarks whose use by third parties for their own purposes could violate the rights of the owner.

### Disclaimer of Liability

We have reviewed the contents of this publication to ensure consistency with the hardware and software described. Since variance cannot be precluded entirely, we cannot guarantee full consistency. However, the information in this publication is reviewed regularly and any necessary corrections are included in subsequent editions.

# Table of contents

<b>1</b>	<b>Introduction.....</b>	<b>9</b>
1.1	About these instructions.....	9
1.2	Text attributes.....	9
1.3	Copyright.....	9
<b>2</b>	<b>Safety instructions.....</b>	<b>11</b>
2.1	General information.....	11
2.2	Intended use.....	13
2.3	Safety instructions for a coupling for use in potentially explosive atmospheres.....	13
2.3.1	Marking.....	13
2.3.2	Conditions of use.....	15
2.4	General warning notices.....	16
<b>3</b>	<b>Description.....</b>	<b>19</b>
<b>4</b>	<b>Application planning.....</b>	<b>23</b>
4.1	Transport of the coupling.....	23
4.2	Storage of the coupling.....	23
<b>5</b>	<b>Assembly.....</b>	<b>25</b>
5.1	Preparatory work.....	25
5.1.1	Milling the parallel keyway.....	26
5.1.2	Milling the parallel keyway.....	27
5.1.3	Machining an axial locking mechanism.....	27
5.1.4	Balancing the coupling.....	30
5.2	Assembling the coupling.....	31
5.2.1	Assembling coupling parts with shaft and hub connected by a parallel key.....	31
5.2.2	Assembling coupling parts with shaft and hub connected by a pressurised oil interference fit.....	32
5.2.3	Assembling the axial backlash limitation.....	33
5.3	Aligning the coupling.....	34
5.3.1	Purpose of alignment.....	34
5.3.2	Possible misalignment.....	35
5.3.2.1	Axial misalignment.....	35
5.3.2.2	Angular misalignment.....	36
5.3.2.3	Radial misalignment.....	36
5.3.2.4	Axial backlash.....	36
<b>6</b>	<b>Commissioning.....</b>	<b>37</b>
<b>7</b>	<b>Operation.....</b>	<b>39</b>
7.1	Normal operation of the coupling.....	39

7.2	Faults - causes and rectification.....	39
7.2.1	Procedure in the event of malfunctions.....	39
7.2.2	Identifying the fault cause.....	39
7.2.2.1	Possible faults.....	40
7.2.2.2	Possible causes.....	41
7.2.3	Correcting faults.....	42
7.2.3.1	Replacing wearing parts.....	42
7.2.3.2	Correcting the changed alignment.....	43
<b>8</b>	<b>Servicing.....</b>	<b>45</b>
8.1	Maintenance intervals.....	45
8.2	Maximum permissible torsional backlash.....	46
8.3	Replacing wearing parts.....	46
8.3.1	Replacing buffers (5) up to coupling size 400.....	47
8.3.2	Replacing buffers (5) as of coupling size 450 to 630.....	48
8.3.3	Replacing buffers (5) as of coupling size 710.....	49
8.3.3.1	Replacing buffers (5) without removing the bolts (4).....	49
8.3.3.2	Replacing buffers (5) with removal of the bolts (4) and (30).....	49
8.3.4	Pressing out bolts.....	50
8.3.4.1	Pressing out bolts (4) and (30) with the "dismounting box".....	50
8.3.4.2	Pressing out bolts (4) and (30) with grease.....	51
8.3.4.3	Potential problems when pressing out bolts (4) and (30) with grease.....	52
8.4	Removing coupling part 1 (1) or 2 (2).....	52
8.4.1	Removing coupling part 1 (1) or 2 (2) with shaft and hub connected by a parallel key.....	52
8.4.2	Removing coupling part 1 (1) or 2 (2) with shaft and hub connected by a pressurised oil interference fit.....	53
<b>9</b>	<b>Service and support.....</b>	<b>57</b>
9.1	Contact.....	57
<b>10</b>	<b>Disposal.....</b>	<b>59</b>
<b>11</b>	<b>Spare parts.....</b>	<b>61</b>
11.1	Ordering spare parts.....	61
11.2	Spare parts drawing and spare parts list.....	63
<b>A</b>	<b>Technical data.....</b>	<b>67</b>
A.1	Speeds, geometry data and weights.....	67
A.1.1	Types RWN and RWS with axial backlash limitation.....	67
A.2	Shaft misalignment values during operation.....	70
A.3	Tightening torques and widths A/F.....	70
A.4	Tightening procedure.....	72
A.5	Buffers (5).....	72
A.5.1	Use and storage of the buffers (5).....	72
A.5.2	RUPEX buffers (5).....	73
<b>B</b>	<b>Quality documents.....</b>	<b>75</b>
B.1	Declaration of Conformity.....	75

**Tables**

Table 2-1	General warnings.....	11
Table 2-2	Temperature classes (TX) for explosive atmospheres as a result of gases, vapours or mists.....	16
Table 2-3	Maximum surface temperature (TX) for an explosive atmosphere as a result of dust/air mixtures.....	16
Table 4-1	Types of preservative agents for long-term storage.....	24
Table 5-1	Recommended assigned fits for bores with parallel key connection.....	26
Table 5-2	Tapped hole, tightening torque and width A/F for type RWN.....	28
Table 5-3	Tapped hole, tightening torque and width A/F for type RWS.....	29
Table 7-1	Table of faults.....	40
Table 8-1	Maintenance intervals.....	45
Table 8-2	Maximum permissible torsional backlash for the types RWN, RWS with axial backlash limitation.....	46
Table 11-1	Spare parts list for types RWN and RWS with axial backlash limitation.....	64
Table A-1	Type RWN with axial backlash limitation.....	67
Table A-2	Type RWS with axial backlash limitation.....	69
Table A-3	Maximum permissible shaft misalignment values during operation.....	70
Table A-4	Tightening torques and widths A/F of bolt connection.....	70
Table A-5	Tightening torques and widths A/F of axial backlash limitation.....	71
Table A-6	Tightening procedure.....	72
Table A-7	RUPEX buffers.....	73

**Figures**

Figure 3-1	Types RWN and RWS with axial backlash limitation.....	20
Figure 3-2	Bolt connection.....	21
Figure 4-1	Transport symbols.....	23
Figure 5-1	Tolerances for the finished bore in coupling part 1 (1) or 2 (2).....	27
Figure 5-2	Dimensions for drilling the parallel keyway.....	28
Figure 5-3	Position of the balancing bore for two-plane balancing.....	30
Figure 5-4	Adjusting the axial backlash of the coupling.....	34
Figure 5-5	Possible misalignment.....	35
Figure 8-1	Markings for calculating the torsional backlash.....	46
Figure 11-1	Spare parts drawing for types RWN and RWS with axial backlash limitation.....	63
Figure 11-2	Screw plug.....	64
Figure A-1	Types RWN and RWS with axial backlash limitation.....	67





# Introduction

## 1.1 About these instructions

These instructions describe the coupling and provide information about its handling - from assembly to maintenance. Please keep these instructions for later use.

Please read these instructions prior to handling the coupling and follow the information in them.

## 1.2 Text attributes

The warning notice system is explained on the back of the inner cover. Always follow the safety information and notices in these instructions.

In addition to the warning notices, which have to be observed without fail, you will find the following text attributes in these instructions:

1. Procedural instructions are shown as a numbered list. Always perform the steps in the order given.

- Lists are formatted as bulleted lists.
  - The dash is used for lists at the second level.

(1) Numbers in brackets are part numbers.

---

### Note

A note is an important item of information about the product, the handling of the product or the relevant section of the instructions. The note provides you with help or further suggestions/ ideas.

---

## 1.3 Copyright

The copyright for these instructions is held by Flender.

These instructions must not be used wholly or in parts without our authorisation or be given to third parties.

If you have any technical queries, please contact our factory or one of our service outlets (refer to Service and support (Page 57)).



## Safety instructions

### 2.1 General information

#### Instructions

These instructions are part of the delivery. Always keep these instructions close to the coupling.

Please make sure that every person who is commissioned to work on the coupling has read and understood these instructions prior to handling the coupling and observes all of the points.

Only the knowledge of these instructions can avoid faults on the coupling and ensure fault-free and safe operation. Non-adherence to the instructions can cause product or property damage or personal injury. Flender does not accept any liability for damage or operating failures that are due to non-adherence to these instructions.







#### State of the art

The coupling described here has been designed in consideration of the latest findings for demanding technical requirements. This coupling is state-of-the-art at the time of printing these instructions.





In the interest of further development, Flender reserves the right to make such changes to the individual components and accessories that increase performance and safety whilst maintaining the essential features.

#### Symbols

Table 2-1 General warnings

ISO	ANSI	Warning
		Warning - hazardous electrical voltage
		Warning - explosive substances
	---	Warning - entanglement hazard
	---	Warning - hot surfaces
	---	Warning - substances that are harmful to health or are irritants

2.1 General information

ISO	ANSI	Warning
	---	Warning - corrosive substances
	---	Warning - suspended load
	---	Warning - hand injuries
		ATEX certification

**Explanation regarding Machinery Directive 2006/42/EC**

The couplings described here are “components” in accordance with the Machinery Directive and do not require a declaration of incorporation.

**ATEX Directive**

The term "ATEX Directive" used in these instructions stands for the harmonisation legislation of the European Union in compliance with the declaration of conformance for equipment and protective systems for correct use in hazardous zones.

**Protective clothing**

In addition to the generally prescribed personal protective equipment (safety shoes, overalls, helmet, etc.), also wear suitable safety gloves and safety goggles when handling the coupling.

**Using the coupling**

The relevant work safety and environmental protection regulations must be complied with at all times during transport, assembly, installation, dismantling, operation and maintenance of the coupling.

Only qualified personnel may operate, assemble, maintain and repair the coupling. Information about qualified personnel can be found in the legal notes at the beginning of these instructions.

If lifting gear or load suspension devices are used for transporting, these have to be suitable for the weight of the coupling.

If the coupling has visible damage, it may not be assembled or put into operation.

The coupling may only be operated in a suitable housing or with touch protection according to applicable standards. This also applies to test runs and rotational direction checks.

**Work on the coupling**

Only carry out work on the coupling when it is not in operation and is not under load.

Secure the drive unit against being switched on accidentally. Attach a notice to the switch stating clearly that work is being carried out on the coupling. Ensure that the entire unit is not under load.

## 2.2 Intended use

Only use the coupling according to the conditions specified in the service and delivery contract and the technical data in the annex. Deviating operating conditions are considered improper use. The user or owner of the machine or plant is solely liable for any resulting damage.

When using the coupling please specifically observe the following:

- Do not make any modifications to the coupling that go beyond the permissible machining described in these instructions. This also applies to touch protection facilities.
- Only use original spare parts from Flender. Flender only accepts liability for original spare parts from Flender.  
Other spare parts are not tested and approved by Flender. Non-approved spare parts may possibly change the design characteristics of the coupling and thus impact active and/or passive safety.  
Flender will accept no liability or warranty whatsoever for damage occurring as a result of the use of non-approved spare parts. The same applies to any accessories that were not supplied by Flender.

If you have any queries, please contact our customer service (see Service and support (Page 57)).

## 2.3 Safety instructions for a coupling for use in potentially explosive atmospheres

### 2.3.1 Marking

You can find a description of the coupling parts in chapter Description (Page 19).

A coupling designed in accordance with the ATEX Directive has a marking on the coupling parts.

#### Coupling part 1 (1) without electrically insulating buffers

One of the following markings is visible on the outer diameter of coupling part 1:

##### Version 1:

Flender GmbH

46393 Bocholt - Germany

FLENDER couplings RUPEX



II 2GD c IIC TX



I M2 c X

<Year of manufacture>

2.3 Safety instructions for a coupling for use in potentially explosive atmospheres

**Version 2:**

Flender GmbH	<b>CE</b>		II 2G c IIC T4/T5/T6 -30 °C ≤ Ta ≤ +80 °C/+70 °C/+55 °C
46393 Bocholt - Germany			II 2D c T 110 °C -30 °C ≤ Ta ≤ +80 °C
FLENDER couplings RUPEX			<Year of manufacture>

**Coupling part 1 with buffers for low-temperature use**

One of the following markings is visible on the outer diameter of coupling part 1:

**Version 1:**

Flender GmbH	<b>CE</b>		II 2GD c IIC TX
46393 Bocholt - Germany			I M2 c X
FLENDER couplings RUPEX			<Year of manufacture>

**Version 2:**

Flender GmbH	<b>CE</b>		II 2G c IIC T6 -50 °C ≤ Ta ≤ +50 °C
46393 Bocholt - Germany			II 2D c T 80 °C -50 °C ≤ Ta ≤ +50 °C
FLENDER couplings RUPEX			<Year of manufacture>

**Coupling part 1 with electrically insulating buffers**

One of the following markings is visible on the outer diameter of coupling part 1:

**Version 1:**

Flender GmbH	<b>CE</b>		II 2GD c IIB TX
46393 Bocholt - Germany			I M2 c X
FLENDER couplings RUPEX			<Year of manufacture>

**Version 2:**

Flender GmbH	<b>CE</b>		II 2G c IIB T4/T5/T6 -30 °C ≤ Ta ≤ +80 °C/+70 °C/+55 °C
46393 Bocholt - Germany			II 2D c T 110 °C -30 °C ≤ Ta ≤ +80 °C
FLENDER couplings RUPEX			<Year of manufacture>

## Coupling part 2 (2)

Coupling part 2 (2) is stamped with .

## Undrilled or predrilled couplings

A coupling part with Ex marking, the letter "U" and the Flender order number has been delivered undrilled or predrilled.

---

### Note

#### Undrilled or predrilled couplings with Ex marking

Flender only supplies an undrilled or predrilled coupling with Ex marking on the condition that the customer assumes the responsibility and liability for correct finishing work in a declaration of exemption.

---

## 2.3.2 Conditions of use

---

### Note

Note also the material-dependent permissible ambient temperature of the buffers (5) in accordance with section RUPEX buffers (5) (Page 73).

---

A coupling designed in accordance with the ATEX Directive is suitable for the following conditions of use:

- Equipment group I
  - Category M2
- Equipment group II
  - Category 2 and 3
  - Group of substances G, zone 1 and 2
  - Group of substances D, zone 21 and 22
  - Explosion group IIA, IIB and IIC
  - Explosion group IIA and IIB when electrically insulating buffers are used

## Conditions of use for products with TX marking

The maximum ambient temperature stated in the following tables applies to the temperature in the direct vicinity of the coupling and the temperature of adjacent components.

2.4 General warning notices

**1. Gases, vapours or mists**

Check the ambient temperature for use of the coupling in the relevant temperature class.

Table 2-2 Temperature classes (TX) for explosive atmospheres as a result of gases, vapours or mists

Max. ambient temperature	Temperature class
80 °C	T4
70 °C	T5
55 °C	T6

**2. Dust/air mixtures**

Check the ambient temperature.

Table 2-3 Maximum surface temperature (TX) for an explosive atmosphere as a result of dust/air mixtures

Max. ambient temperature	Max. surface temperature
80 °C	110 °C

**Notes concerning operation of the coupling in potentially explosive atmospheres**

- Only use the coupling underground in mines in potentially explosive atmospheres together with drive motors that can be switched off in the event of the formation of an explosive atmosphere.
- Earth machines that are connected via the coupling with a leakage resistance of less than 10<sup>6</sup> Ω.
- If you want to use a coated coupling in potentially explosive atmospheres, please note the requirements concerning the conductivity of the paint and the limitation on the paint layer thickness applied in accordance with EN 13463-1. No build-up of electrostatic charges is to be expected with a paint layer thickness of less than 200 µm.

**2.4 General warning notices**



<p><b>! DANGER</b></p> <p><b>Danger due to bursting of the coupling</b></p> <p>The coupling may burst if it is not used properly. There is a risk of fatal injury from flying fragments. Bursting of the coupling can lead to an explosion in potentially explosive atmospheres.</p> <ul style="list-style-type: none"> <li>• Use the coupling for the purpose for which it is intended.</li> </ul>
---





**⚠ DANGER**

**Risk of explosion when using coupling parts without Ex marking**

Coupling parts without Ex marking have not been approved for use in potentially explosive atmospheres. These coupling parts can lead to an explosion during operation.

- Only use couplings with Ex marking in potentially explosive atmospheres.



**⚠ DANGER**

**Danger**

Risk of injury due to the use of unsuitable and/or damaged components. The use of unsuitable and/or damaged components can lead to an explosion in potentially explosive atmospheres.

- Observe the information regarding conditions of use.



**⚠ DANGER**

**Danger of explosion**

Improper operation of the coupling can lead to an explosion in potentially explosive atmospheres.

- Please observe the notes concerning operation of the coupling in potentially explosive atmospheres.



**⚠ DANGER**

**Danger from hot coupling parts**

Risk of injury due to hot surfaces. Hot coupling parts can lead to an explosion in potentially explosive atmospheres.

- Wear suitable protective equipment (gloves, safety goggles).
- Ensure that the area is not at risk of explosion.



**⚠ WARNING**

**Risk of chemical burns due to chemical substances**

There is a risk of chemical burns when handling aggressive cleaning agents.

- Please observe the manufacturer's information on how to handle cleaning agents and solvents.
- Wear suitable protective equipment (gloves, safety goggles).

**⚠ CAUTION**

**Physical injury**

Risk of injury due to falling coupling parts.

- Secure the coupling parts to prevent them from falling.



## Description

The RUPEX couplings described here are torsionally flexible, damping pin and bush couplings and are available in various types and sizes with axial backlash limitation. The couplings can be used in accordance with the ATEX Directive in potentially explosive atmospheres if they have a CE marking.

These instructions describe the assembly and operation of a RUPEX coupling arranged horizontally with a shaft-hub connection made by a cylindrical or conical bore with parallel key or by a pressurised oil interference fit. Please consult Flender if you want to use a different type of installation.

## Application

RUPEX couplings with axial backlash limitation are designed for use in all kinds of machines. They are designed to withstand high torques and harsh operating conditions and are predominantly used in drives in which the motor does not have a separate thrust bearing.

## Design

The illustration shows the various types with their constituent parts and their part numbers.

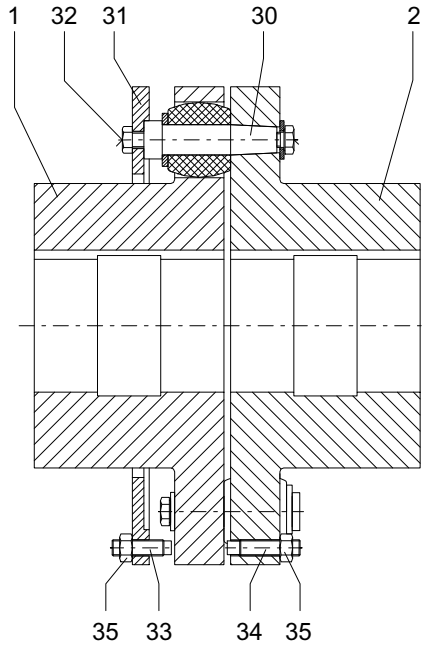

- 1 Coupling part 1
- 2 Coupling part 2
- 30 Bolt
- 31 Retaining ring
- 32 Screw
- 33 Set screw
- 34 Set screw
- 35 Nut

Figure 3-1 Types RWN and RWS with axial backlash limitation

The axial backlash limitation comprises parts 31, 32, 33, 34 and 35.

For applications in potentially explosive atmospheres, use set screws (33) and (34) made of a material that cannot generate any impact sparks, e.g. rigid PVC.

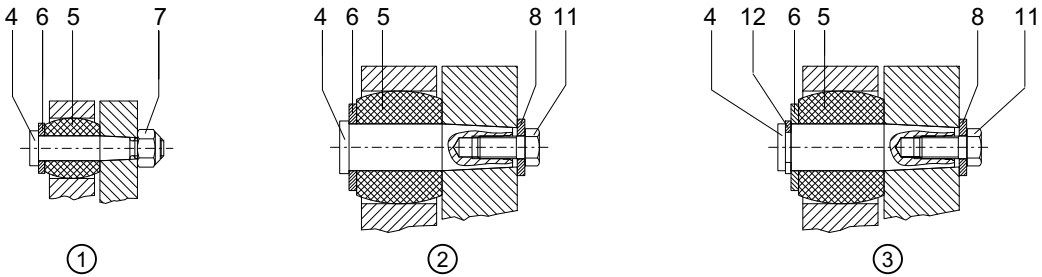

- ① Bolt connection for sizes 285 to 400
- ② Bolt connection for sizes 450 to 630
- ③ Bolt connection for sizes 710 to 1250
- 4 Bolt
- 5 Buffer
- 6 Washer
- 7 Hexagon nut, self-locking
- 8 Washer
- 11 Hexagon head screw
- 12 Locking ring

Figure 3-2 Bolt connection



## Application planning

Check the delivery for damage and for completeness. Report any damage and/or missing parts to Flender immediately.

The coupling is delivered in individual parts and preassembled groups. Preassembled groups may not be dismantled.

### 4.1 Transport of the coupling



<p><b>! WARNING</b></p> <p><b>Severe personal injury due to improper transport</b></p> <p>Severe personal injury due to falling components or due to crushing. Damage to coupling parts possible due to use of unsuitable transport means.</p> <ul style="list-style-type: none"> <li>• Only use lifting gear and load suspension devices with sufficient load bearing capacity for transport.</li> <li>• Please observe the symbols applied on the packaging.</li> </ul>
---

If not specifically contractually agreed otherwise, the packaging complies with the HPE Packaging Directive.

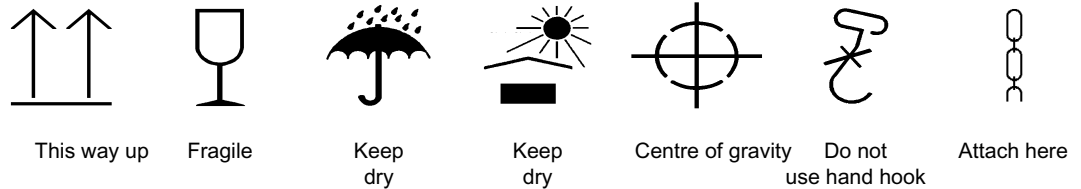

Figure 4-1 Transport symbols

### 4.2 Storage of the coupling

<p><b>NOTICE</b></p> <p><b>Property damage due to improper storage</b></p> <p>Negative changes to the physical properties of the coupling and/or coupling damage.</p> <ul style="list-style-type: none"> <li>• Please observe the information about storing the coupling.</li> </ul>
--

4.2 Storage of the coupling

The coupling, unless not specifically ordered otherwise, is supplied with preservation and can be stored for up to 3 months.

**Note**

**Information about storing the coupling**

- Ensure that the storage room is dry (relative humidity < 65 %) and free of dust.
- Ensure that there is no condensation.
- Do not store the coupling together with corrosive chemicals, acids, caustic solutions, etc.
- If the coupling contains elastomer components, ensure that there are no devices in the storage room that produce ozone, such as fluorescent lights, mercury vapour lamps or high-voltage electrical equipment.
- Store the coupling on suitable supports or in suitable containers.

**Long-term storage**

<b>NOTICE</b>
<b>Property damage due to improper long-term storage</b>
Negative changes to the physical properties of the coupling and/or coupling damage.
<ul style="list-style-type: none"> <li>• Note the handling instructions for long-term storage.</li> </ul>

1. You can find the required type of preservative agent in the following table (types of preservative agents for long-term storage).
2. Remove the elastomer components. These must not come into contact with cleaning agents and long-term preservative agents.
3. Clean the coupling parts.
4. Apply the stipulated preservative agent.
5. Store the coupling parts and the elastomer components separately.

Table 4-1 Types of preservative agents for long-term storage

Preservative agents	Features	Indoor storage	Outdoor storage
Oil spray	Anti-corrosion agent	Up to 12 months	Up to 4 months
Tectyl 846 or similar	Long-term preservative agent on wax basis	Up to 36 months	Up to 12 months
Emulsion cleaner + VCI foil	Active system, reusable	Up to 5 years	Up to 5 years



# Assembly

Assembly of the coupling comprises the following steps:

- Preparatory work (Page 25)
- Assembling the coupling (Page 31)
- Aligning the coupling (Page 34)



## DANGER

### Danger due to bursting of the coupling

If you do not observe the information stipulated here regarding assembly, this can lead to bursting of the coupling during operation. There is a risk of fatal injury from flying fragments. Bursting of the coupling can lead to an explosion in potentially explosive atmospheres.

- Please observe all the stipulations concerning assembly.

### Note

#### Information about the assembly of the coupling

- Only use undamaged components for the assembly of the coupling.
- Follow the assembly sequence.
- Please ensure that there is sufficient space at the assembly location and that the location is tidy and clean in order to be able to assemble and maintain the coupling without any risk.
- If a dimension drawing has been created for the coupling, please observe the information it contains as a matter of priority.

## 5.1 Preparatory work

### Note

Please consult Flender if you want to machine a conical finished bore.

Carry out the following steps if the coupling does not have a finished bore:

- Milling the parallel keyway (Page 26)
- Milling the parallel keyway (Page 27)
- Machining an axial locking mechanism (Page 27)
- Balancing the coupling (Page 30)

**Note**

The customer is responsible for execution of the finishing work on the coupling. Flender shall have no liability whatsoever for claims under warranty arising from finishing work that has not been carried out adequately.

**5.1.1 Milling the parallel keyway**

The diameter of the finished bore depends on the shaft used.

**Recommended assigned fits**

In the following table you can find the recommended assigned fits for bores with a parallel key connection. The assigned fit m6 / H7 is especially suitable for a host of applications.

Table 5-1 Recommended assigned fits for bores with parallel key connection

Description	Push fit		Press fit		Interference fit		
	Not suitable for reversing operation		Suitable for reversing operation				
Shaft tolerance	j6	h6	h6	k6	<b>m6</b>	n6	h6
Bore tolerance	H7	J7	K7	H7	<b>H7</b>	H7	M7

**Procedure**

1. Remove the retaining ring (31) and the set screws (34) with the nuts (35).
2. Remove the bolts (4) and/or (30) and the buffers (5). For further information, refer to section Replacing wearing parts (Page 46).
3. Remove the preservation and clean the coupling parts 1 (1) and/or 2 (2) to be machined.

4. Clamp the coupling to the areas marked with  in the diagram below.
5. Machine the finished bore in accordance with the diagram below.

**Note**

**Diameter of the finished bore**

The diameter of the finished bore may not exceed the specified maximum diameter.

- Please observe the maximum diameters specified in section Speeds, geometry data and weights (Page 67).

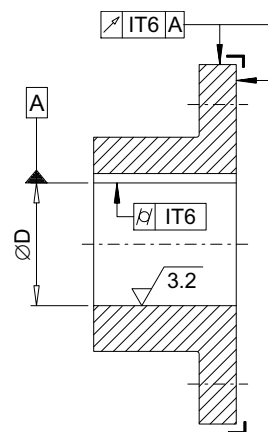

Figure 5-1 Tolerances for the finished bore in coupling part 1 (1) or 2 (2)

## 5.1.2 Milling the parallel keyway

### Position of the parallel keyway

Arrange the parallel keyway in the centre between two adjacent buffer fitting holes or bolt fitting holes.

### Applicable standards

- If the coupling is intended for use under normal operating conditions, mill the parallel keyway according to DIN 6885/1 ISO JS9.
- If the coupling is intended for reversing operation, mill the parallel keyway according to DIN 6885/1 ISO P9.
- If you want to mill a parallel keyway that does not correspond to DIN 6885/1, please consult Flender.

## 5.1.3 Machining an axial locking mechanism

The coupling part is secured by a set screw or an end plate to prevent axial movements.

Please consult Flender if you want to use an end plate.

Note the following when using a set screw:

- Diameter and axial position of the tapped hole in the hub
- Position of the tapped hole with respect to the parallel keyway
- Selection of the set screw

**Diameter and axial position of the tapped hole in the hub**

The axial position of the tapped hole is in the centre of the hub.

The diagram below shows the dimensions for drilling the parallel keyway through the tapped hole.

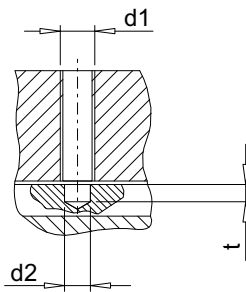

①

① Hole for the set screw with dog point according to ISO 4028

Figure 5-2 Dimensions for drilling the parallel keyway

The following tables contain the values for the diameter of the tapped hole depending on the finished bore.

Table 5-2 Tapped hole, tightening torque and width A/F for type RWN

Finished bore		Tapped hole	d <sub>2</sub> mm	t mm	Tightening torque T <sub>A</sub> Nm	Width across flats Hexagon socket wrench mm
over mm	up to mm	d <sub>1</sub>				
48	65	M10	7	2.5	15	5
65	95	M12	8.5	3	25	6
95	110	M16	12	4	70	8
110	150	M20	15	5	130	10
150	230	M24	18	6	230	12
230	600	M30	24	7	470	14

Apply the recommended tightening torques in accordance with the stipulations in section Tightening procedure (Page 72).

Table 5-3 Tapped hole, tightening torque and width A/F for type RWS

Finished bore		Tapped hole			Tightening torque $T_A$ Nm	Width across flats  Hexagon socket wrench mm
over mm	up to mm	$d_1$	$d_2$ mm	t mm		
48	75	M8	5.5	2	8	4
75	95	M12	8.5	3	25	6
95	110	M16	12	4	70	8
110	150	M20	15	5	130	10
150	230	M24	18	6	230	12
230	600	M30	24	7	470	14

Apply the recommended tightening torques in accordance with the stipulations in section Tightening procedure (Page 72).

### Position of the tapped hole with respect to the parallel keyway

The tapped hole for the set screw is positioned on the parallel keyway.

### Selection of the set screw

 <b>CAUTION</b>
<b>Physical injury</b>
Danger of injury from protruding set screw.
<ul style="list-style-type: none"> <li>• Please observe the information about selecting the set screw.</li> </ul>

Use set screws with dog point in accordance with ISO 4028. The size of the set screw is determined by the bore made. The set screw should fill out the tapped hole as much as possible and must not protrude beyond the hub.

### 5.1.4 Balancing the coupling

#### Notes on balancing the coupling

**NOTICE**

**Damage to coupling part 1 (1) or 2 (2) or to retaining ring (31)**

If you completely drill through the flange on coupling part 1 (1) or 2 (2) or on the retaining ring (31), then coupling part 1 (1) or 2 (2) or the retaining ring is no longer allowed to be used for operation.

- Please observe the stipulations about machining the balancing hole.

Please note the following when balancing the coupling:

- Select the balancing quality according to the application (but at least G16 in accordance with DIN ISO 21940).
- Observe the balancing specification according to DIN ISO 21940-32.
- Machine the balancing bore on a large radius with adequate clearance to the buffer fitting holes, the bolt fitting holes and the outer circumference.
- Balance the coupling parts in two planes. Balance the coupling part 2 (2) together with the axial backlash limitation. The axial backlash limitation comprises parts 31, 32, 33, 34 and 35.

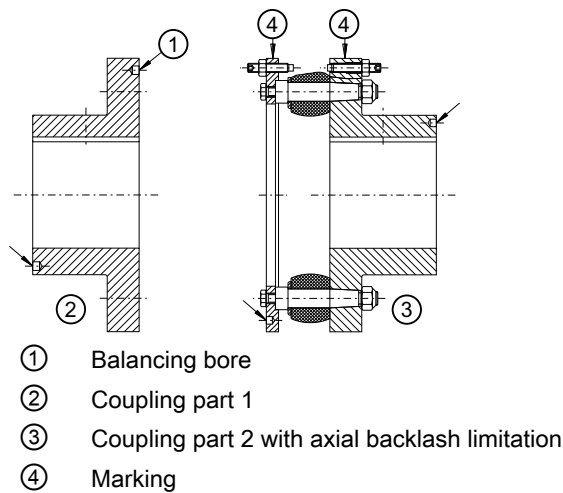

Figure 5-3 Position of the balancing bore for two-plane balancing

#### Procedure

1. Fit the bolts (30) and buffers (5). For further information, refer to section Replacing wearing parts (Page 46).
2. Fit the retaining ring (31).
3. Tighten the screws (32) to the specified tightening torque  $T_A$  (see Tightening torques and widths A/F (Page 70)).

4. Screw the set screws (33) into the retaining ring (31). All the set screws (33) must be inserted to the same depth.
5. Secure the set screws (33) with the nuts (35).
6. Screw the set screws (34) into the coupling part 2 (2). All the set screws (34) must be inserted to the same depth.
7. Secure the set screws (34) with the nuts (35).
8. Balance the coupling as illustrated in the diagram above.
9. Mark the retaining ring (31) and the coupling part 2 (2).

## 5.2 Assembling the coupling

<b>NOTICE</b>
<b>Property damage</b>
Damage to the elastomer components from cleaning agents.
<ul style="list-style-type: none"> <li>• Ensure that the elastomer components do not come into contact with cleaning agents.</li> </ul>

<b>NOTICE</b>
<b>Property damage</b>
Damage to the shaft end, the coupling parts and/or the parallel key.
<ul style="list-style-type: none"> <li>• Note the handling instructions regarding assembly of the coupling parts.</li> </ul>

Assembly of the coupling comprises the following steps:

- Assembling coupling parts with shaft and hub connected by a parallel key (Page 31)
- Assembling coupling parts with shaft and hub connected by a pressurised oil interference fit (Page 32)
- Assembling the axial backlash limitation (Page 33)

### 5.2.1 Assembling coupling parts with shaft and hub connected by a parallel key

#### Procedure

1. Remove the retaining ring (31).
2. Unscrew the set screw until it is no longer possible for there to be a collision with the parallel key or the shaft.
3. Clean the bores and shaft ends.
4. Coat the bores of coupling parts 1 (1) and/or 2 (2) and the shafts with MoS<sub>2</sub> assembly paste (e.g. Microgleit LP 405).

5. Mount the retaining ring (31) on the shaft before fitting the coupling part 1 (1). Make sure that the retaining ring (31) cannot obstruct mounting of the coupling part 1 (1).
  6. Mount the coupling parts 1 (1) and/or 2 (2) on the shaft.
- 

**Note**

**Coupling parts with conical bore**

Mount the coupling parts 1 (1) and/or 2 (2) with conical bore and parallel keyway on the shaft in cold condition. Secure the coupling parts with suitable end plates without pulling the coupling parts further onto the cone (fitting dimension = 0).

---

**Note**

**Coupling parts with cylindrical bore**

To make assembly easier, you can heat coupling parts 1 (1) and/or 2 (2) with cylindrical bore up to a maximum of 150 °C if required. Note when doing this the temperature range of the buffers (5) (see section RUPEX buffers (5) (Page 73)). Remove the buffers (5) if necessary. For further information, refer to section Replacing wearing parts (Page 46). Protect adjacent components against damage and heating to temperatures above 80 °C.

---

7. When securing with a set screw the shaft must not protrude or be set back from the inner side of the hub. Drill the parallel key in the shaft through the tapped hole in the hub. Please observe the relevant information in section Machining an axial locking mechanism (Page 27).
8. Clean the parts to remove any impurities.
9. Secure the coupling parts 1 (1) and/or 2 (2) with a set screw or an end plate.
10. Tighten up the set screw or the screw to attach the end plate to the specified tightening torque  $T_A$  (for the set screw please see section Machining an axial locking mechanism (Page 27)).
11. If you have removed the buffers (5), reinstall them. For further information, refer to section Replacing wearing parts (Page 46).

### 5.2.2 Assembling coupling parts with shaft and hub connected by a pressurised oil interference fit

#### Procedure

1. Remove the retaining ring (31).
2. Remove the buffers (5). For further information, refer to section Replacing wearing parts (Page 46).
3. Remove the screw plugs (101) and/or (201) from the coupling parts 1 (1) and/or 2 (2).
4. Clean, degrease, de-oil and dry the hub bores and shaft ends.
5. Clean and dry the oil channels and the oil circulation grooves.
6. Protect adjacent components against damage and heating to temperatures above 80 °C.



7. Mount the retaining ring (31) on the shaft before fitting the coupling part 1 (1). Make sure that the retaining ring (31) cannot obstruct mounting of the coupling part 1 (1).
8. Heat up the coupling parts 1 (1) and/or 2 (2) to the temperature specified in the dimension drawing.  
Make sure that no dirt or contaminants can soil the bores again during the heating process.
9. Mount the coupling parts 1 (1) and/or 2 (2) quickly on the shaft according to the instructions in the dimension drawing.
10. Secure the coupling parts to stop them from moving until they have cooled down.
11. Allow the coupling parts to cool down to the ambient temperature.
12. Use an end plate to secure the coupling parts that have a non-self-locking, tapered pressurised oil interference fit.
13. In order to protect the oil channels of the coupling parts 1 (1) and/or 2 (2) against corrosion, fill them with a suitable pressurised oil and seal the oil channels with the screw plugs (101) and/or (201).
14. Assemble the buffers (5). For further information, refer to section Replacing wearing parts (Page 46).

### 5.2.3 Assembling the axial backlash limitation

#### Procedure

1. If the motor does not have any axial location bearings, you need to determine the axial backlash of the rotor. If you do not find any marking on the shaft nor any other information pertaining to the axial backlash, you can determine the mid-point of the rotor axial backlash by performing a trial run.
2. Hold the shaft in the axial position that corresponds to the mid-point of the rotor axial clearance.
3. Move the machines to be coupled together, taking the dimension S into account. The values for the dimension S can be found in section Speeds, geometry data and weights (Page 67).
4. Fit the retaining ring (31). Observe any markings that might be provided.
5. Apply a few drops of liquid screw locking agent (e.g. Loctite 243) to the screws (32).

5.3 Aligning the coupling

- 6. Tighten the screws (32) to the specified tightening torque  $T_A$  (see section Tightening torques and widths A/F (Page 70)).
- 7. Adjust the axial backlash of the coupling with the set screws (33) and (34) to approximately half the calculated motor axial clearance, making sure that the dimension \* is equal in size on both sides. Note the permissible deviation for the dimension S (for dimension S see section Speeds, geometry data and weights (Page 67)).

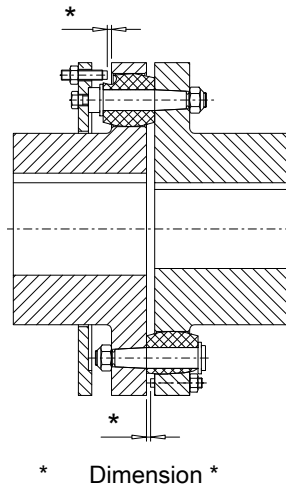

Figure 5-4 Adjusting the axial backlash of the coupling

Example

Axial backlash of the electric motor	=	8 mm
Axial backlash of the coupling	=	4 mm
Axial backlash per coupling part (dimension *)	=	2 mm

5.3 Aligning the coupling

While aligning, hold the shaft in the axial position that corresponds to the mid-point of the rotor axial clearance.

5.3.1 Purpose of alignment

The shafts that are joined by the coupling are never on an ideal precise axis but have a certain amount of misalignment.

Misalignment in the coupling leads to restoring forces that can stress adjacent machine parts (e.g. the bearings) to an unacceptable extent.

The misalignment values in operation result from the following:

- Misalignment due to assembly  
Incorrect position due to a lack of precision when aligning
- Misalignment due to operation  
Example: Load-related deformation, thermal expansion

You can minimise misalignment by aligning after assembly. A lower misalignment in the coupling has the following advantages:

- Reduced wear of the elastomer components
- Reduced restoring forces
- Misalignment reserves for operation of the coupling

You can find the maximum permitted shaft misalignment values during operation in section Shaft misalignment values during operation (Page 70).

### 5.3.2 Possible misalignment

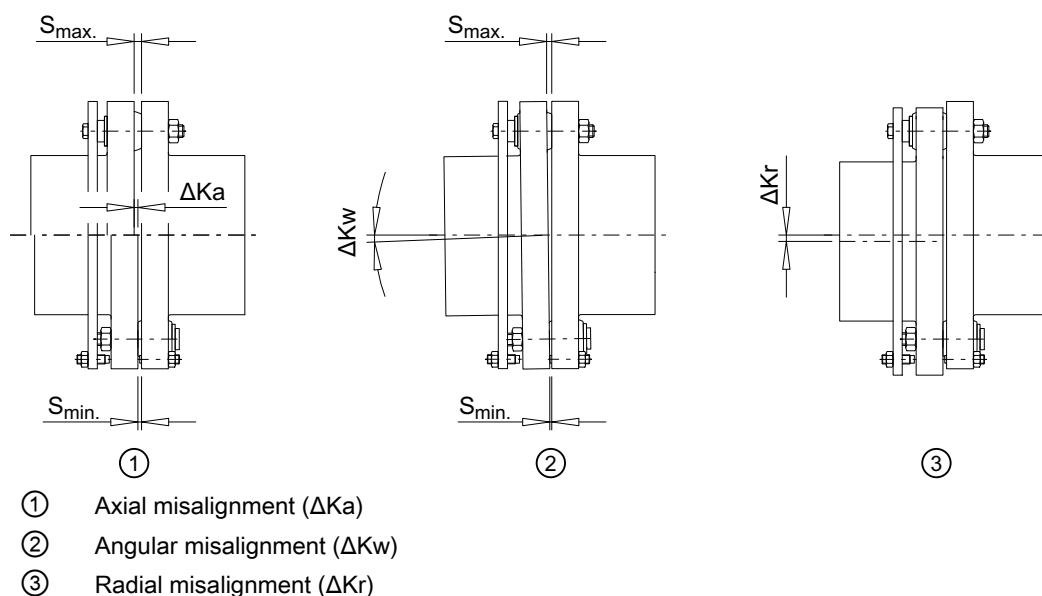

Figure 5-5 Possible misalignment

#### 5.3.2.1 Axial misalignment

Set the axial misalignment  $\Delta K_a$  to a value within the permissible tolerance range of dimension S.

You can find the values for dimension S in section Speeds, geometry data and weights (Page 67).

### 5.3.2.2 Angular misalignment

Determine the value  $\Delta S$  ( $\Delta S = S_{\max} - S_{\min}$ ). The determined value  $\Delta S$  may not exceed the value  $\Delta S_{\text{perm}}$ .

You can find the values for  $\Delta S_{\text{perm}}$  in section Shaft misalignment values during operation (Page 70).

If required, you can calculate the angular misalignment  $\Delta Kw$  as follows:

$$\Delta Kw [\text{rad}] = \Delta S / DA$$

$$\Delta Kw [\text{deg}] = (\Delta S / DA) \cdot (180 / \pi)$$

If required, you can calculate the permissible angular misalignment  $\Delta Kw_{\text{perm}}$  as follows:

$$\Delta Kw_{\text{perm}} [\text{rad}] = \Delta S_{\text{perm}} / DA$$

$$\Delta Kw_{\text{perm}} [\text{deg}] = (\Delta S_{\text{perm}} / DA) \cdot (180 / \pi)$$

DA in mm see section Speeds, geometry data and weights (Page 67)

$\Delta S_{\text{perm}}$  see section Shaft misalignment values during operation (Page 70)

### 5.3.2.3 Radial misalignment

Determine the value  $\Delta Kr$ . The determined value  $\Delta Kr$  may not exceed the value  $\Delta Kr_{\text{perm}}$ .

You can find the permissible radial misalignment  $\Delta Kr_{\text{perm}}$  in section Shaft misalignment values during operation (Page 70).

### 5.3.2.4 Axial backlash

Check the adjusted axial backlash. It must be at least large enough to allow the coupling to compensate for the resultant angular deviation.

Tighten the nuts (35) to the specified tightening torque  $T_A$  (see section Tightening torques and widths A/F (Page 70)).



**! DANGER**

**Danger due to igniting deposits**

During use in potentially explosive atmospheres deposits from heavy metal oxides (rust) can ignite due to friction, impact or friction sparks and lead to an explosion.

- Ensure through the use of an enclosure or other suitable measures that the deposition of heavy metal oxides (rust) on the coupling is not possible.

In order to ensure safe commissioning, carry out various tests prior to commissioning.

## Testing before commissioning



**! DANGER**

**Danger**

Overload conditions can occur during the commissioning of the coupling. The coupling can burst and metal parts can be flung out. There is a risk of fatal injury from flying fragments. Bursting of the coupling can lead to an explosion in potentially explosive atmospheres.

- Carry out the tests prior to commissioning.
- Do not touch the rotating coupling.

1. Check the tightening torques of the screws of the coupling in accordance with section Tightening torques and widths A/F (Page 70).
2. Check the tightening torques of the foundation bolts of the coupled machines.
3. Check whether the enclosures (coupling guard, touch protection) have been installed and that the function of the coupling has not been adversely affected by the enclosure. This also applies to test runs and rotational direction checks.



## Operation

### 7.1 Normal operation of the coupling

The coupling runs quietly and shock-free during normal operation.

### 7.2 Faults - causes and rectification

A form of behaviour which is different to normal operation is classed as a fault and has to be rectified immediately.

Look out specifically for the following faults during coupling operation:

- Unusual coupling noise
- Sudden occurrence of shocks

#### 7.2.1 Procedure in the event of malfunctions



#### **! DANGER**

##### **Danger due to bursting of the coupling**

There is a risk of fatal injury from flying fragments. Bursting of the coupling can lead to an explosion in potentially explosive atmospheres.

- Switch off the unit at once if any malfunctions occur.
- Note during the maintenance work the possible causes of faults and the notes on rectifying them.

Proceed as described below if there is a malfunction of the coupling during operation:

1. De-energise the drive immediately.
2. Initiate the required action for repair, taking into consideration the applicable safety regulations.

If you cannot determine the cause or if you cannot carry out repair work with your own means, request one of our customer service technicians.

#### 7.2.2 Identifying the fault cause

Faults occur frequently due to application errors or they occur due to operational circumstances such as wear of wearing parts or changes to the system.

The faults and fault causes listed below only serve as an indication for troubleshooting. In the case of a complex system be sure to include all the system components in the search for the fault.



	<p><b>WARNING</b></p> <p><b>Physical injury</b></p> <p>Injury from rotating parts.</p> <ul style="list-style-type: none"> <li>• Only carry out work on the coupling when it is not moving.</li> <li>• Secure the drive unit against being operated accidentally.</li> <li>• Attach a notice to the switch stating clearly that work is being carried out on the coupling.</li> <li>• Before starting any work, make sure that the unit is free from loads.</li> </ul>
--	---

**Intended use**

The coupling is only approved for the applications specified in these instructions. Please observe all the stipulations in section Intended use (Page 13).

**7.2.2.1 Possible faults**

Table 7-1 Table of faults

<b>Fault</b>	<b>Cause</b>	<b>Rectification</b>
Sudden changes in the noise level and/or sudden occurrences of shocks	Wear of wearing parts	Follow the instructions given in section Replacing wearing parts (Page 42).
	Changed alignment	Follow the instructions given in section Correcting the changed alignment (Page 43).
	Coupling not suitable for the operating conditions. Check the possible causes given in section Unsuitable coupling (Page 41).	Use a coupling that is suitable for the operating conditions.
	Incorrect assembly of the coupling. Check the possible causes given in sections Assembly-related causes (Page 41) and Specific installation-related and maintenance-related causes (Page 42).	Reassemble the coupling in accordance with these instructions. Please observe all the stipulations and requirements given in chapter Assembly (Page 25).
	Incorrect maintenance of the coupling. Check the possible causes given in sections Maintenance-related causes (Page 42) and Specific installation-related and maintenance-related causes (Page 42).	Please observe all the stipulations and requirements given in chapter Servicing (Page 45).



Fault	Cause	Rectification
Presence of vibration	Coupling not suitable for the operating conditions. Check the possible causes given in section Unsuitable coupling (Page 41).	Use a coupling that is suitable for the operating conditions.
	Incorrect assembly of the coupling. Check the possible causes given in sections Assembly-related causes (Page 41) and Specific installation-related and maintenance-related causes (Page 42).	Reassemble the coupling in accordance with these instructions. Please observe all the stipulations and requirements given in chapter Assembly (Page 25).
	Incorrect maintenance of the coupling. Check the possible causes given in sections Maintenance-related causes (Page 42) and Specific installation-related and maintenance-related causes (Page 42).	Please observe all the stipulations and requirements given in chapter Servicing (Page 45).

### 7.2.2.2 Possible causes

#### Unsuitable coupling

- Important information on the description of the drive unit and the environment were not available when the coupling was chosen.
- System torque too high and/or torque dynamics not permissible.
- System speed too high.
- Application factor not selected correctly.
- Chemically aggressive environment not taken into consideration.
- Coupling not suitable for the ambient temperature.
- Diameter and/or assigned fit of the finished bore not permissible.
- Width across corners of the parallel keyways greater than the width across corners of the parallel keyways in accordance with DIN 6885/1 for the maximum permissible bore.
- Shaft-hub connection incorrectly sized.
- Maximum permissible load conditions not taken into consideration.
- Maximum permissible overload conditions not taken into consideration.
- Dynamic load conditions not taken into consideration.
- Coupling and the machine and/or drive train form a critical torsional, axial or bending vibration system.

#### Assembly-related causes

- Damaged parts installed.
- Shaft diameter outside the stipulated tolerance range.

- Coupling parts interchanged and hence not assigned to the specified shaft.
- Stipulated locking elements to prevent axial movements not installed.
- Stipulated tightening torques not adhered to.
- Bolts inserted dry or greased.
- Flange surfaces of screwed connections not cleaned.
- Alignment and/or shaft misalignment values not set in accordance with the instructions.
- Coupled machines were not correctly connected to the foundation so that a shifting of the machines leads to an impermissible displacement of the coupling parts.
- Coupled machines not earthed adequately.
- Coupling guard used is not suitable.

### **Maintenance-related causes**

- Stipulated maintenance intervals not adhered to.
- Spare parts that were used were not original spare parts from Flender.
- Flender spare parts that were used were old or damaged.
- Leak in the area of the coupling not detected so that chemically aggressive substances damage the coupling.
- Indications of faults, such as noise or vibration, were not heeded.
- Stipulated tightening torques not adhered to.
- Alignment and/or shaft misalignment values not set in accordance with the instructions.

### **Specific installation-related and maintenance-related causes**

- Buffers (5) not fitted.
- Fitted buffers (5) heated up excessively when applying heat to the coupling parts.
- Buffers (5) are of different types or age.
- Buffers (5) not replaced as sets.
- Mounting position of marked components not taken into account during installation.

## **7.2.3 Correcting faults**

### **7.2.3.1 Replacing wearing parts**

Buffers (5) are subject to wear and this wear can result in torsional backlash.

**Procedure**

1. Check the wear on the buffers (5) (see section Maximum permissible torsional backlash (Page 46)).
2. Replace the buffers (5) where appropriate (see section Replacing wearing parts (Page 46)).

**7.2.3.2 Correcting the changed alignment**

A changed alignment of the coupling during operation often occurs when the coupled machines shift towards one another. A cause of this can be loose foundation bolts.

**Procedure**

1. Correct the cause for the change in alignment.
2. Check the wearing parts for wear and replace them as required.
3. Check the locking elements that prevent axial movements and correct these as required.
4. Realign the coupling.



## 8.1 Maintenance intervals



<p><b>! DANGER</b></p> <p><b>Danger due to bursting of the coupling</b></p> <p>The coupling can burst if the maintenance intervals are not adhered to. There is a risk of fatal injury from flying fragments. Bursting of the coupling can lead to an explosion in potentially explosive atmospheres.</p> <ul style="list-style-type: none"> <li>• Please observe all the stipulations concerning maintenance of the coupling in this section.</li> </ul>
---



<p><b>! DANGER</b></p> <p><b>Danger due to bursting of the coupling</b></p> <p>The coupling can burst if the maximum permitted torsional backlash is exceeded. There is a risk of fatal injury from flying fragments. Bursting of the coupling can lead to an explosion in potentially explosive atmospheres.</p> <ul style="list-style-type: none"> <li>• Note also the actual wear of the elastomer components.</li> </ul>
--



<p><b>! WARNING</b></p> <p><b>Physical injury</b></p> <p>Injury from rotating parts.</p> <ul style="list-style-type: none"> <li>• Only carry out work on the coupling when it is not moving.</li> <li>• Secure the drive unit against being operated accidentally.</li> <li>• Attach a notice to the switch stating clearly that work is being carried out on the coupling.</li> <li>• Before starting any work, make sure that the unit is free from loads.</li> </ul>
---

Check the torsional backlash between the coupling halves at the specified maintenance intervals. The maximum permissible torsional backlash for the various coupling sizes can be found in section Maximum permissible torsional backlash (Page 46).

Table 8-1 Maintenance intervals

Type	Initial maintenance	Follow-up maintenance
RWN	3 months after commissioning	Every 12 months
RWS		

**Note**

**Shorter maintenance intervals**

If necessary, set shorter maintenance intervals depending on actual wear.

## 8.2 Maximum permissible torsional backlash

In order to calculate the torsional backlash, rotate one coupling part without applying torque up to the stop. Mark both of the coupling halves in the way shown in the diagram below. Turn the coupling part in the opposite direction up to the stop. The markings on both halves will then move apart. The distance between the markings corresponds to the torsional backlash.

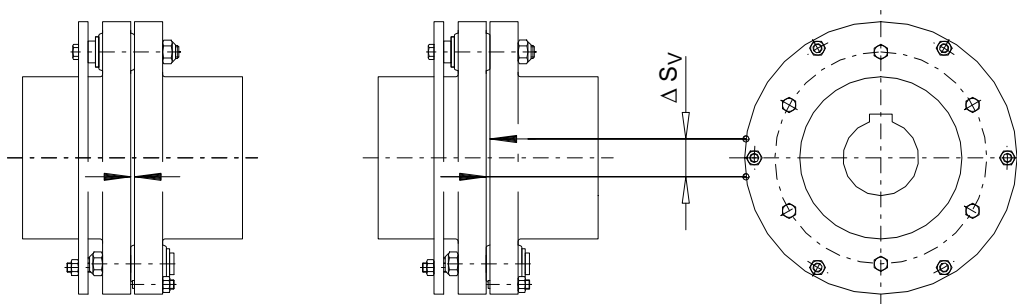

Figure 8-1 Markings for calculating the torsional backlash

Table 8-2 Maximum permissible torsional backlash for the types RWN, RWS with axial backlash limitation

Size	285	360	450	560	710	900	1 120
	320	400	500	630	800	1 000	1 250
Maximum permissible torsional backlash $\Delta S_v$ [mm]	6.0	7.0	8.5	10.0	12.0	13.5	15.0

## 8.3 Replacing wearing parts



### **! DANGER**

#### **Danger due to bursting of the coupling**

If you do not observe the information stipulated here regarding replacement of wearing parts, this can lead to bursting of the coupling during operation. There is a risk of fatal injury from flying fragments. Bursting of the coupling can lead to an explosion in potentially explosive atmospheres.

- Please observe all the stipulations concerning the replacement of wearing parts.



### **! DANGER**

#### **Danger due to impact sparks**

Set screws (33) and (34) made of unsuitable material can cause explosions.

- For applications in potentially explosive atmospheres, use set screws (33) and (34) made of a material that cannot generate any impact sparks, e.g. rigid PVC.

**NOTICE****Property damage**

If you replace parts 30, 31, 32, 33, 34 and 35 of the axial backlash limitation, you might need to remachine the parts.

- Contact Flender.

Replace the buffers (5) if the maximum permissible torsional backlash has been reached. The method used to replace the buffers (5) and remove the bolts (4) and (30) varies according to the coupling size.

- Up to coupling size 400  
Replacing buffers (5) up to coupling size 400 (Page 47)
- From coupling size 450 to 630  
Replacing buffers (5) as of coupling size 450 to 630 (Page 48)
- From coupling size 710  
Replacing buffers (5) as of coupling size 710 (Page 49)

### 8.3.1 Replacing buffers (5) up to coupling size 400

#### Procedure

1. Remove the screws (32).
2. Place the retaining ring (31) on the hub.
3. Remove the hexagon nuts (7).
4. Remove the bolts (4) and (30) with the washers (6) and the buffers (5) through the buffer fitting holes.
5. Pull the buffers (5) off the bolts (4) and (30).
6. Clean the bolts (4) and (30), the washers (6), the buffer fitting holes and the bolt fitting holes in the coupling parts 1 (1) and/or 2 (2).
7. Mount new buffers (5) on the bolts (4) and (30).  
Please observe the information in section Use and storage of the buffers (5) (Page 72) when replacing the buffers (5).
8. Insert the bolts (4) with the washers (6) and the buffers (5) through the buffer fitting holes into the bolt fitting holes of the coupling part 1 (1). Observe any markings that might be provided.
9. The bolt fitting holes in the coupling part 2 (2) and the bolts (30) are labelled sequentially. Insert the bolts (30) with the washers (6) and the buffers (5) through the buffer fitting holes into the matching bolt fitting holes of the coupling part 2 (2).
10. Secure the bolts (4) and (30) with new hexagon nuts (7) of the same quality.
11. Tighten the hexagon nuts (7) to the specified tightening torque  $T_A$  (see section Tightening torques and widths A/F (Page 70)).

12. Fit the retaining ring (31). Observe any markings that might be provided.
13. Apply a few drops of liquid screw locking agent (e.g. Loctite 243) to the screws (32).
14. Tighten the screws (32) to the specified tightening torque  $T_A$  (see section Tightening torques and widths A/F (Page 70)).

### 8.3.2 Replacing buffers (5) as of coupling size 450 to 630

<b>NOTICE</b>
<b>Blockage of cross bore of bolts (4) and (30)</b>
The liquid screw locking agent can seal the cross bore of the bolts (4) and (30). Pressing out the bolts (4) and (30) with grease then becomes difficult or completely impossible.
<ul style="list-style-type: none"><li>• Apply only a small quantity of the liquid screw locking agent to the screws (11).</li></ul>

When removing the bolts (4) and (30), please observe the information in section Pressing out bolts (Page 50).

#### Procedure

1. Remove the screws (32).
2. Place the retaining ring (31) on the hub.
3. Remove the hexagon head screws (11) and the washers (8).
4. Remove the bolts (4) and (30) with the buffers (5) through the buffer fitting holes.
5. Pull the buffers (5) off the bolts (4) and (30).
6. Clean the bolts (4) and (30), the washers (6), the buffer fitting holes and the bolt fitting holes in the coupling parts 1 (1) and/or 2 (2).
7. Mount new buffers (5) on the bolts (4) and (30). Please observe the information in section Use and storage of the buffers (5) (Page 72) when replacing the buffers (5).
8. Insert the bolts (4) with the washers (6) and the buffers (5) through the buffer fitting holes into the bolt fitting holes of the coupling part 1 (1). Observe any markings that might be provided.
9. The bolt fitting holes in the coupling part 2 (2) and the bolts (30) are labelled sequentially. Insert the bolts (30) with the washers (6) and the buffers (5) through the buffer fitting holes into the matching bolt fitting holes of the coupling part 2 (2).
10. Push the washers (8) onto the screws (11).
11. Apply a small quantity of liquid screw locking agent (e.g. Loctite 243) to the screws (11).
12. Secure the bolts (4) and (30) with the screws (11) and washers (8).
13. Tighten the screws (11) to the specified tightening torque  $T_A$  (see section Tightening torques and widths A/F (Page 70)).



14. Fit the retaining ring (31). Observe any markings that might be provided.
15. Apply a few drops of liquid screw locking agent (e.g. Loctite 243) to the screws (32).
16. Tighten the screws (32) to the specified tightening torque  $T_A$  (see section Tightening torques and widths A/F (Page 70)).

### 8.3.3 Replacing buffers (5) as of coupling size 710

You can use the following methods to replace the buffers (5) on couplings of size 710 or larger.

- Replacing buffers (5) without removing the bolts (4) (Page 49)
- Replacing buffers (5) with removal of the bolts (4) and (30) (Page 49)

#### 8.3.3.1 Replacing buffers (5) without removing the bolts (4)

The procedure described here applies exclusively to the bolts (4).

In order to replace the buffers (5) on the bolts (30), you must first remove the bolts (30).

#### Procedure

1. Remove the locking rings (12) and the washers (6).
2. Pull out the buffers (5) through the buffer fitting holes.
3. Clean the bolts (4) and the buffer fitting holes in the coupling part 2 (2).
4. Mount new buffers (5) on the bolts (4). Please observe the information in section Use and storage of the buffers (5) (Page 72) when replacing the buffers (5).
5. Secure the buffers (5) with the washers (6) and the locking rings (12).

#### 8.3.3.2 Replacing buffers (5) with removal of the bolts (4) and (30)

##### NOTICE

##### Blockage of cross bore of bolts (4) and (30)

The liquid screw locking agent can seal the cross bore of the bolts (4) and (30). Pressing out the bolts (4) and (30) with grease then becomes difficult or completely impossible.

- Apply only a small quantity of the liquid screw locking agent to the screws (11).

#### Procedure

1. Remove the screws (32).
2. Place the retaining ring (31) on the hub.

3. Remove the bolts (4) and (30). Please observe the relevant information in section Pressing out bolts (Page 50).
4. Remove the locking rings (12) and the washers (6).
5. Pull the buffers (5) off the bolts (4) and (30).
6. Clean the bolts (4) and (30), the washers (6), the locking rings (12), the buffer fitting holes and the bolt fitting holes in the coupling parts 1 (1) and/or 2 (2).  
If old bolts (4) and (30) are to be reused, the tapped holes and cross bores must be completely free of any residues of grease or liquid screw locking agent.
7. Mount new buffers (5) on the bolts (4) and (30). Please observe the information in section Use and storage of the buffers (5) (Page 72) when replacing the buffers (5).
8. Secure the buffers (5) with the washers (6) and the locking rings (12).
9. Insert the bolts (4) with the buffers (5) into the bolt fitting holes of the coupling part 1 (1).  
Observe any markings that might be provided.
10. The bolt fitting holes in the coupling part 2 (2) and the bolts (30) are labelled sequentially.  
Insert the bolts (30) with the washers (6) and the buffers (5) through the buffer fitting holes into the matching bolt fitting holes of the coupling part 2 (2).
11. Push the washers (8) onto the screws (11).
12. Apply a small quantity of liquid screw locking agent (e.g. Loctite 243) to the screws (11).
13. Secure the bolts (4) and (30) with the screws (11) and washers (8).
14. Tighten the screws (11) to the specified tightening torque  $T_A$  (see section Tightening torques and widths A/F (Page 70)).
15. Fit the retaining ring (31). Observe any markings that might be provided.
16. Apply a few drops of liquid screw locking agent (e.g. Loctite 243) to the screws (32).
17. Tighten the screws (32) to the specified tightening torque  $T_A$  (see section Tightening torques and widths A/F (Page 70)).

### 8.3.4 Pressing out bolts

The bolts (4) and (30) for coupling sizes 450 to 1 250 have cross bores that make it easier to press out the bolts (4) and (30).

#### 8.3.4.1 Pressing out bolts (4) and (30) with the "demounting box"

Flender can supply a "demounting box" which is a hydraulic press-out fixture for removing bolts. Flender can supply the demounting box on request.

---

#### Note

#### Separate operating instructions

If you use the "demounting box" to remove the bolts (4) and (30), please observe the operating instructions BA 3600.1, "Demounting box for extraction of RUPEX bolts".

---

## 8.3.4.2 Pressing out bolts (4) and (30) with grease

	<b>WARNING</b>
<b>Risk of injury from flying bolts (4) and (30)</b>	
Loose bolts (4) and (30) can become detached from the coupling and fly through the air like a projectile.	
<ul style="list-style-type: none"> <li>Secure the bolt axially by placing the washer (8) over screw (11) before you insert the screw (11) into the tapped hole of the bolt.</li> </ul>	



	<b>WARNING</b>
<b>Risk of crush injuries as a result of bolt (4) and (30) suddenly working loose</b>	
If bolt (4) and (30) suddenly works loose, the screw (11) and the washer (8) can be abruptly set in motion.	
<ul style="list-style-type: none"> <li>While you are pressing out bolts, do not place your hands in the area around bolt (4) and (30), screw (11) or washer (8).</li> </ul>	

	<b>WARNING</b>
<b>Risk of injury</b>	
When you are pressing out the bolts (4) and (30), grease can escape under high pressure. If bolt (4) and (30) suddenly works loose, fragments can become detached and fly through the air at high speed.	
<ul style="list-style-type: none"> <li>Wear safety goggles.</li> </ul>	

## Procedure

1. Remove the screws (32).
2. Place the retaining ring (31) on the hub.
3. Remove the hexagon head screws (11) and the washers (8).
4. Clean the tapped holes of the bolts (4) and (30) until they are free of all residues.
5. Fill the tapped hole of a bolt (4) or (30) to 90 % with commercially available machine grease (e.g. Fuchs Renolit H443-HD-88).
6. Wrap screw (11) in Teflon tape or Teflon sealing cord.
7. Place a washer (8) as an axial locking element over screw (11).
8. Insert the screw (11) with the washer (8) into the bolt (4) or (30) and tighten manually by two to three turns.
9. Using a spanner, continue turning the screw (11) slowly into the thread so that the grease is pressed evenly through the cross bore between the bolt (4) or (30) and the bolt fitting hole of the coupling part 1 (1) and/or 2 (2).  
The bolt (4) or (30) is released suddenly and makes a loud noise.
10. Repeat the process in the order specified for all the installed bolts (4) and (30).

8.3.4.3 Potential problems when pressing out bolts (4) and (30) with grease

Problem	Cause	Possible solutions
Bolt (4) or (30) is not released despite the fact that the screw is fully inserted.	Pressure is too low to release the bolt (4) or (30).	<ul style="list-style-type: none"> <li>• Use a longer screw (11) (minimum strength class 8.8).</li> <li>• Fill more grease into the tapped hole of the bolt (4) or (30).</li> </ul>
Bolts (4) or (30) are difficult or impossible to release.	Liquid locking agent for screws (11) has sealed the cross bore.	Clean the tapped hole and the cross bore of the bolt (4) or (30).
Grease is escaping. Bolt (4) or (30) is not released.	The tapped hole is not sufficiently sealed.	<ol style="list-style-type: none"> <li>1. Remove the screw (11).</li> <li>2. Seal the screw (11) again in Teflon tape or Teflon sealing cord.</li> <li>3. Press out the bolt (4) or (30) again with grease.</li> </ol>

8.4 Removing coupling part 1 (1) or 2 (2)

The procedure to be followed depends on the existing shaft-hub connection:

- Removing coupling part 1 (1) or 2 (2) with shaft and hub connected by a parallel key (Page 52)
- Removing coupling part 1 (1) or 2 (2) with shaft and hub connected by a pressurised oil interference fit (Page 53)

8.4.1 Removing coupling part 1 (1) or 2 (2) with shaft and hub connected by a parallel key



<p><b>! WARNING</b></p> <p><b>Danger from burners and hot coupling parts</b></p> <p>Risk of injury due to burners and hot surfaces. Burners or hot coupling parts can lead to an explosion in potentially explosive atmospheres.</p> <ul style="list-style-type: none"> <li>• Wear suitable protective equipment (gloves, safety goggles).</li> <li>• Ensure that the area is not at risk of explosion.</li> </ul>
--

Procedure

1. Remove the screws (32).
2. Place the retaining ring (31) on the hub. Make sure that the retaining ring (31) cannot obstruct removal of the coupling part 1 (1) and secure it in position to prevent it from falling.

3. Move the coupled machines apart.
4. Secure the coupling parts to prevent them from falling.
5. Remove the axial locking element (set screw, end plate).
6. Use a suitable pulling fixture.
7. Heat up the coupling part 1 (1) and/or 2 (2) using a burner above the parallel keyway along its length to maximum 80 °C.  
Note when doing this the permissible temperature range of the buffers (5) (refer to section RUPEX buffers (5) (Page 73)). Remove the buffers (5) if necessary.
8. Pull off the coupling part 1 (1) and/or 2 (2). Use suitable lifting gear when doing this.
9. Check the hub bore and the shaft for damage and protect them against corrosion.
10. Replace any damaged parts.

When reinstalling the coupling parts please observe the information in chapters Assembly (Page 25) and Commissioning (Page 37).

#### 8.4.2 Removing coupling part 1 (1) or 2 (2) with shaft and hub connected by a pressurised oil interference fit



##### DANGER

###### **Oil pressure in excess of maximum permissible value**

The coupling can burst. There is a risk of fatal injury from flying fragments. Bursting of the coupling can lead to an explosion in potentially explosive atmospheres.

- Do not exceed the maximum oil pressure specified in the dimension drawing.
- Keep the oil pressure constant in all oil channels during the entire procedure.



##### DANGER

###### **Danger as a result of improper handling of fixtures and pumps**

Failure to handle fixtures and pumps properly can result in injuries. The coupling can burst. There is a risk of fatal injury from flying fragments. Bursting of the coupling can lead to an explosion in potentially explosive atmospheres.

- Please observe the manufacturer's information on handling the following tools:
  - Pulling fixtures
  - Pumps



**WARNING**

**Risk of injury as a result of coupling components or the pulling fixture working loose**

Coupling components or pulling fixtures can work loose and fall when dismantling work is in progress.

- Use suitable hoisting gear to hold the coupling part 1 (1) or 2 (2) and the pulling fixture in position.
- Attach an axial locking element if the pressurised oil interference fit is tapered.

**Note**

**Leaking oil**

1. When dismantling the coupling part, catch any oil which escapes.
2. Dispose of the oil according to the valid regulations.

**Tools required**

- One oil pump with pressure gauge (at least 2500 bar) per oil channel.  
Or:  
One motor-driven oil pump. One connection that can be closed independently is required for each oil channel.

Refer to the dimension drawing for the number of oil channels.

- With a stepped bore:  
A motor-driven pump at the oil channel located at the point of transition from the smaller to the larger bore. A large quantity of oil per unit of time is needed here.
- Suitable connections and pipes.
- Suitable pulling fixture.  
Or:  
Retaining plate with retaining screws or threaded spindles with nuts. Material of the screws or spindles at least strength class 10.9, material of the nuts depending on the material of the screws or spindles.
- Hydraulic cylinder with oil pump. Note displacement and pressure of the hydraulic cylinder. Refer to the dimension drawing for the required axial force.

**Procedure**

1. Remove the screws (32).
2. Place the retaining ring (31) on the hub. Make sure that the retaining ring (31) cannot obstruct removal of the coupling part 1 (1) and secure it in position to prevent it from falling.
3. Move the coupled machines apart.
4. Remove the buffers (5). For further information, refer to section Replacing wearing parts (Page 46).
5. Use a suitable pulling fixture.

6. Secure the coupling part 1 (1) or 2 (2) and the pulling fixture in position to prevent them from falling.
7. Remove the screw plugs (101) or (201) from the oil channels.
8. Deaerate an oil pump and connect it to the oil channel in the centre.
9. Pressurise the oil pump to the pressure specified in the dimension drawing until oil starts to escape from the adjacent connections or the front faces. Keep the pressure constant.
10. Deaerate the next oil pump and connect it to the adjacent oil channel.
11. Repeat steps 9 and 10 on the remaining oil channels.
12. If so much oil escapes when pressure is applied that the pump cannot maintain the pressure, use a higher-viscosity oil.
13. Pressurise the hydraulic cylinder if oil escapes from both front faces as a closed oil ring. Make sure that the coupling part 1 (1) or 2 (2) is pulled immediately off the shaft in a swift, smooth movement.

---

**Note****Removal in several strokes**

If several strokes of the hydraulic cylinder are required to remove the part, make sure that the shaft end is positioned between two oil channels after each individual stroke.

---

14. Dismantle the oil pumps and the pulling fixture from the coupling part 1 (1) or 2 (2) .
15. Check the hub bore and the shaft for damage and protect them against corrosion.
16. Replace any damaged parts.

When reinstalling the coupling parts please observe the information in chapters Assembly (Page 25) and Commissioning (Page 37).





## Service and support

### 9.1 Contact

#### Contact

When ordering spare parts, requesting a customer service technician or in the case of technical queries, please contact our factory or one of our customer service addresses:

Flender GmbH

Schlavenhorst 100

46395 Bocholt

Germany

Tel.: +49 (0)2871/92-0

Fax.: +49 (0)2871/92-2596



## Disposal

### Disposal of the coupling

Dispose of the coupling parts according to applicable national regulations or recycle them.



## Spare parts

### 11.1 Ordering spare parts

By stocking the most important spare parts at the installation site you can ensure that the coupling is ready for use at any time.

---

**Note****Original spare parts**

Only use original spare parts from Flender. Flender only accepts liability for original spare parts from Flender.

Other spare parts are not tested and approved by Flender. Non-approved spare parts may possibly change the design characteristics of the coupling and thus impact active and/or passive safety.

Flender will accept no liability or warranty whatsoever for damage occurring as a result of the use of non-approved spare parts. The same applies to any accessories that were not supplied by Flender.

---

You can find the available spare parts for the coupling described here at Spare parts drawing and spare parts list (Page 63).

You will find our contact data for ordering spare parts in Service and support (Page 57).

#### Information required when ordering spare parts

- Flender order number with item
- Flender drawing number
- Coupling type and size
- Part number (refer to Spare parts drawing and spare parts list (Page 63))
- Dimensions of the spare part, for example:
  - Bore
  - Bore tolerance
  - Parallel keyway and balancing
- Special dimensions, for example, flange connection dimensions, intermediate sleeve length or brake drum dimensions

*11.1 Ordering spare parts*

- Any special properties of the spare part, such as, for example:
  - Temperature resistance
  - Electrical insulation
  - Operating fluid
  - Use in potentially explosive atmospheres
- Quantity

## 11.2 Spare parts drawing and spare parts list

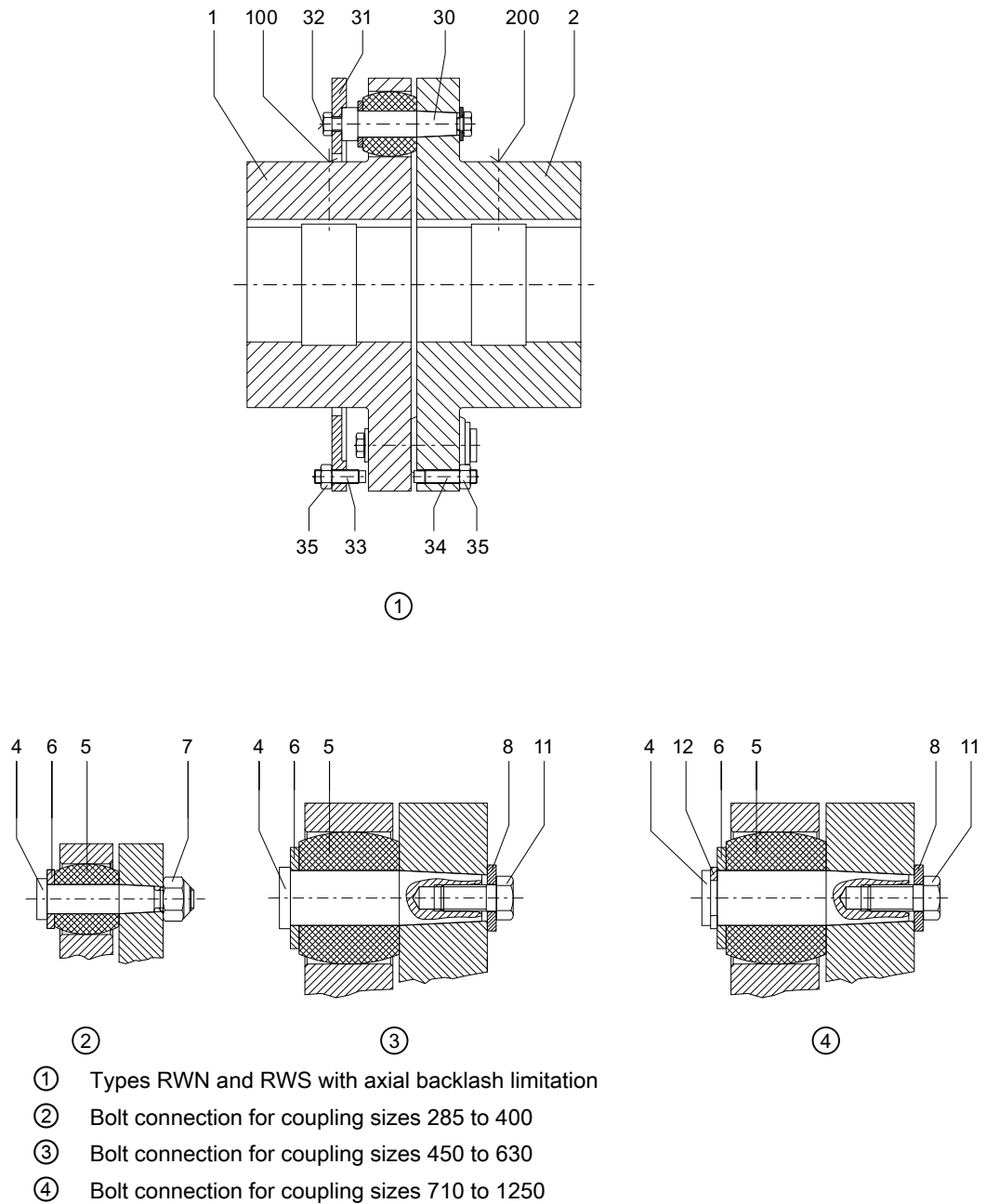

Figure 11-1 Spare parts drawing for types RWN and RWS with axial backlash limitation

**Note****Arrangement of the buffers**

The buffers (5) are arranged on one side in the coupling part 1 (1) up to coupling size 360. With coupling size 400 or larger, the buffers (5) are arranged alternately in coupling part 1 (1) and coupling part 2 (2).

The bolts (30) are always located in the bolt fitting holes of coupling part 2 (2).

Table 11-1 Spare parts list for types RWN and RWS with axial backlash limitation

Part number	Designation
1	Coupling part 1
2	Coupling part 2
4	Bolt
5	Buffer
6	Washer
7	Hexagon nut, self-locking
8	Washer
11	Hexagon head screw
12	Locking ring
30	Bolt
31	Retaining ring
32	Screw
33	Set screw <sup>1)</sup>
34	Set screw <sup>1)</sup>
35	Nut
100	Set screw ISO 4028
101	Screw plug <sup>2)</sup>
200	Set screw ISO 4028
201	Screw plug <sup>2)</sup>

1) For applications in potentially explosive atmospheres, use set screws (33) and (34) made of a material that cannot generate any impact sparks, e.g. rigid PVC.

2) Screw plugs (101, 201) are only used in combination with a pressurised oil interference fit.

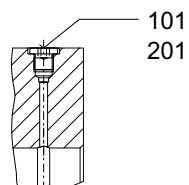

Figure 11-2 Screw plug



---

**Note**

If you replace parts 30, 31, 32, 33, 34 and 35 of the axial backlash limitation, you might need to remachine the parts.

- Contact Flender.
-

*Spare parts*

---

*11.2 Spare parts drawing and spare parts list*

## Technical data

### A.1 Speeds, geometry data and weights

In this section you can find dimension drawings and technical data for RUPEX couplings of the following types:

- Types RWN and RWS with axial backlash limitation (Page 67)

#### A.1.1 Types RWN and RWS with axial backlash limitation

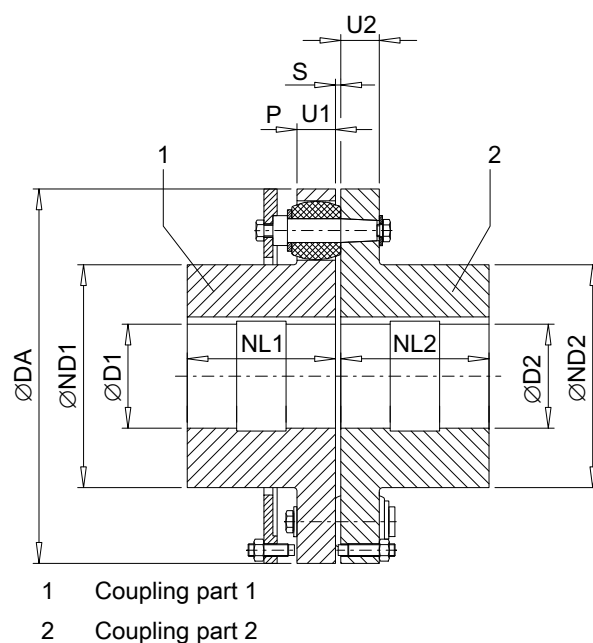

Figure A-1 Types RWN and RWS with axial backlash limitation

Table A-1 Type RWN with axial backlash limitation

Size	Speed $n_{max}$ rpm	Maximum bore <sup>1)</sup>		DA	ND1	ND2	NL1 NL2	P	S	U1	U2	Weight <sup>2)</sup> m kg
		D1	D2									
285	2 650	100	110	285	164	175	110	60	3 ... 6	32	30	45
320	2 350	110	120	320	180	192	125	60	3 ... 6	32	30	58
360	2 100	120	130	360	200	210	140	75	3 ... 6	42	42	85
400	2 050	140	140	400	230	230	160	75	3 ... 6	42	42	115

Technical data

A.1 Speeds, geometry data and weights

Size	Speed	Maximum bore <sup>1)</sup>		DA	ND1	ND2	NL1 NL2	P	S	U1	U2	Weight <sup>2)</sup>
		D1	D2									m
		rpm	mm									mm
<b>450</b>	1 800	160	160	450	260	260	180	90	4 ... 7	52	52	165
<b>500</b>	1 600	180	180	500	290	290	200	90	4 ... 7	52	52	235
<b>560</b>	1 450	140	140	560	250	250	220	120	4 ... 8	68	68	295
		180	180		300	300						310
		200	200		320	320						310
<b>630</b>	1 280	140	140	630	250	250	240	120	4 ... 8	68	68	375
		180	180		300	300						395
		220	220		355	355						420
<b>710</b>	1 150	160	160	710	290	290	260	140	5 ... 9	80	80	545
		200	200		330	330						535
		240	240		385	385						580
<b>800</b>	1 000	180	180	800	320	320	290	140	5 ... 9	80	80	705
		220	220		360	360						715
		260	260		420	420						765
<b>900</b>	900	220	220	900	360	360	320	160	5 ... 10	90	90	965
		260	260		425	425						1 030
		290	290		465	465						1 060
<b>1 000</b>	810	240	240	1 000	395	395	350	160	5 ... 10	90	90	1 240
		280	280		460	460						1 320
		320	320		515	515						1 390
<b>1 120</b>	700	200	200	1 120	360	360	380	180	6 ... 11	100	100	1 650
		250	250		410	410						1 640
		300	300		495	495						1 800
		350	350		560	560						1 870
<b>1 250</b>	650	230	230	1 250	410	410	420	180	6 ... 11	100	100	2 100
		280	280		460	460						2 150
		330	330		540	540						2 280
		380	380		610	610						2 410

<sup>1)</sup> Maximum bore for parallel keyway in accordance with DIN 6885/1.

<sup>2)</sup> Weight applies to one coupling with maximum bore.

Table A-2 Type RWS with axial backlash limitation

Size	Speed $n_{max}$ rpm	Maximum bore <sup>1)</sup>		DA	ND1	ND2	NL1 NL2	P	S	U1	U2	Weight <sup>2)</sup> m kg
		D1	D2									
		mm	mm									
<b>285</b>	3 900	110	120	285	164	175	110	60	3 ... 6	32	30	45
<b>320</b>	3 500	125	130	320	180	192	125	60	3 ... 6	32	30	58
<b>360</b>	3 100	135	140	360	200	210	140	75	3 ... 6	42	42	85
<b>400</b>	2 800	150	150	400	230	230	160	75	3 ... 6	42	42	115
<b>450</b>	2 500	170	170	450	260	260	180	90	4 ... 7	52	52	170
<b>500</b>	2 200	190	190	500	290	290	200	90	4 ... 7	52	52	215
<b>560</b>	2 000	165	165	560	250	250	220	120	4 ... 8	68	68	295
		200	200		300	300						315
		210	210		320	320						325
<b>630</b>	1 800	165	165	630	250	250	240	120	4 ... 8	68	68	385
		200	200		300	300						405
		235	235		355	355						435
<b>710</b>	1 600	190	190	710	290	290	260	140	5 ... 9	80	80	555
		220	220		330	330						570
		250	250		385	385						610
<b>800</b>	1 400	210	210	800	320	320	290	140	5 ... 9	80	80	720
		240	240		360	360						740
		280	280		420	420						785
<b>900</b>	1250	210	210	900	320	320	320	160	5 ... 10	90	90	980
		240	240		360	360						1 010
		280	280		425	425						1 070
		310	310		465	465						1 100
<b>1 000</b>	1 100	230	230	1 000	355	355	350	160	5 ... 10	90	90	1 260
		260	260		395	395						1 300
		300	300		460	460						1 380
		340	340		515	515						1 440
<b>1 120</b>	1 000	240	240	1 120	360	360	380	180	6 ... 11	100	100	1 700
		270	270		410	410						1 760
		330	330		495	495						1 860
		370	370		560	560						1 960
<b>1 250</b>	900	270	270	1 250	410	410	420	180	6 ... 11	100	100	2 210
		300	300		460	460						2 290
		360	360		540	540						2 400
		400	400		610	610						2 560

<sup>1)</sup> Maximum bore for parallel keyway in accordance with DIN 6885/1.

<sup>2)</sup> Weight applies to one coupling with maximum bore.

A.2 Shaft misalignment values during operation

## A.2 Shaft misalignment values during operation

The following table shows the maximum permissible shaft misalignment values  $\Delta S_{perm}$  and  $\Delta K r_{perm}$ . The values are rounded and specified in mm.

Table A-3 Maximum permissible shaft misalignment values during operation

Size	Coupling speed [rpm]								
	250	500	750	1 000	1 500	2 000	3 000	4 000	5 000
285	0.95	0.65	0.55	0.45	0.4	0.3	0.25		
320	1.05	0.75	0.6	0.5	0.4	0.35	0.3		
360	1.15	0.8	0.65	0.55	0.45	0.4	0.3		
400	1.25	0.85	0.7	0.6	0.5	0.45			
450	1.35	0.95	0.8	0.7	0.55	0.45			
500	1.5	1.05	0.85	0.75	0.6	0.5			
560	1.65	1.15	0.95	0.8	0.65	0.55			
630	1.85	1.3	1.05	0.9	0.75				
710	2.05	1.45	1.15	1	0.8				
800	2.25	1.6	1.3	1.1					
900	2.5	1.75	1.45	1.25					
1 000	2.75	1.95	1.6	1.35					
1 120	3.05	2.15	1.75	1.5					
1 250	3.4	2.4	1.95						

You can calculate the numerical values in the table and their intermediate values as follows:

$$\Delta K r_{perm} = \Delta S_{perm} = (0.1 + DA / 1000) \cdot 40 / \sqrt{n}$$

Coupling speed n in rpm  
DA in mm (see Speeds, geometry data and weights (Page 67))  
Radial misalignment  $\Delta K r_{perm}$  in mm

The values in column "250 rpm" of the table above apply for speeds of < 250 rpm.

## A.3 Tightening torques and widths A/F

Use bolts of strength class 8.8

Table A-4 Tightening torques and widths A/F of bolt connection

Size	Tightening torque	Width A/F external hexagon
	$T_A$ Part 7, 11 Nm	SW Part 7, 11 mm
285	100	24
320	100	24

A.3 Tightening torques and widths A/F

Size	Tightening torque		Width A/F external hexagon
	$T_A$ Part 7, 11 Nm		SW Part 7, 11 mm
360	170		27
400	170		27
450	180		24
500	180		24
560	340		30
630	340		30
710	580		36
800	580		36
900	600		36
1 000	600		36
1 120	1 150		46
1 250	1 150		46

Apply the recommended tightening torques in accordance with the stipulations in section Tightening procedure (Page 72).

Table A-5 Tightening torques and widths A/F of axial backlash limitation

Size	Tightening torque			Width A/F external hexagon	
	$T_A$			SW	
	Part 32	Part 35		Part 32	Part 35
		for standard set screws (33, 34)	for special set screws (33; 34) <sup>1)</sup>		
	Nm	Nm	Nm	mm	mm
285	60	49	10	17	17
320	60	49	10	17	17
360	105	86	10	19	19
400	105	86	10	19	19
450	255	210	10	24	24
500	255	210	10	24	24
560	500	210	10	30	24
630	500	410	20	30	30
710	870	710	20	36	36
800	870	710	20	36	36
900	870	710	20	36	36
1 000	870	710	20	36	36

Size	Tightening torque			Width A/F external hexagon	
	T <sub>A</sub>			SW	
	Part 32	Part 35		Part 32	Part 35
		for standard set screws (33, 34)	for special set screws (33; 34) <sup>1)</sup>		
	Nm	Nm	Nm	mm	mm
1 120	1 750	710	20	46	36
1 250	1 750	710	20	46	36

<sup>1)</sup> For applications in potentially explosive atmospheres, use set screws (33) and (34) made of a material that cannot generate any impact sparks, e.g. rigid PVC.

Apply the recommended tightening torques in accordance with the stipulations in section Tightening procedure (Page 72).

## A.4 Tightening procedure

Tighten fastening screws to the specified tightening torque in accordance with the following table:

Table A-6 Tightening procedure

Scatter of the torque applied at the tool	Tightening procedure (As a rule, the tightening procedures listed are within the specified tool torque scatter)
±5 %	<ul style="list-style-type: none"> <li>Hydraulic tightening with mechanical screwdriver</li> <li>Torque-controlled tightening with a torque wrench or a torque wrench that gives a signal</li> <li>Tightening with a precision mechanical screwdriver with dynamic torque measurement</li> </ul>

The tightening torques apply to screws/bolts with untreated surfaces that are not oiled or are only lightly oiled, and for screws/bolts that are used with a liquid screw locking agent in accordance with these instructions. Use with lubricant paint or lubricant is not permitted.

## A.5 Buffers (5)

### A.5.1 Use and storage of the buffers (5)

Note the following concerning the use and storage of the buffers (5):

- Storage possible for up to 5 years
- Protect against direct sunlight, artificial light with a high UV-content and extreme temperatures



- Avoid contact with aggressive media
- Only replace complete sets
- Only use buffers (5) of the same type and age

## A.5.2 RUPEX buffers (5)

Table A-7 RUPEX buffers

Material	Hardness	Comment	Marking	Ambient temperature	Approved for explosion group
NBR	80 Shore A	Standard	Black buffer	-30 °C to +80 °C	IIA, IIB, IIC
NBR	65 Shore A	Special, soft, shifting of the resonant speed, rated torque reduced	Black buffer with green dot on front face	-30 °C to +80 °C	IIA, IIB, IIC
NBR	90 Shore A	Special, hard, shifting of the resonant speed	Black buffer with magenta dot on front face	-30 °C to +80 °C	IIA, IIB, IIC
NBR 639	80 Shore A	Special, electrically insulating	Green buffer	-30 °C to +80 °C	IIA, IIB
NR	80 Shore A	Special, low-temperature use	Black buffer with white dot on front face	-50 °C to +50 °C	IIA, IIB, IIC
HNBR	80 Shore A	Special, high-temperature use	Black buffer with red dot on front face	-10 °C to +100 °C	Not approved



## Quality documents

### B.1 Declaration of Conformity

**EU declaration of conformity**

Product:

FLENDER RUPEX® couplings  
Types RWN and RWS  
with axial backlash limitation

Name and address of the manufacturer:

Flender GmbH  
Schlavenhorst 100  
46395 Bocholt  
Deutschland – Germany

This declaration of conformity is issued under the sole responsibility of the manufacturer.

Object of the declaration is the product specified above.

The object of the declaration described above is in conformity with the relevant harmonisation legislation of the Union:

– Directive 2014/34/EU                      Official Journal L 96, 29.3.2014, pages 309-356

Harmonised standards or other technical specifications, on which the declaration of conformity is based:

EN 1127-1                      : 2011  
EN 1710                        : 2008  
EN 13463-1                    : 2009  
EN 13463-5                    : 2011

The notified body, DEKRA EXAM GmbH, code number 0158, has received the technical documentation.

Signed for and on behalf of:  
Flender GmbH



Bocholt, 2017-10-01

i.V.

\_\_\_\_\_  
Felix Henseler, Head of PD MD AP



Bocholt, 2017-10-01

i.V.

\_\_\_\_\_  
Thomas Tebrügge, Head of PD MD AP COU BA



# FLENDER COUPLINGS

---

RUPEX

Operating Instructions 3601en

Edition 10/2017

---

**Flender GmbH**

Alfred-Flender-Straße 77

46395 Bocholt

GERMANY

[flender.com](http://flender.com)

**FLENDER**  
A Siemens Company